

PRODUCT DESCRIPTION

- The open style structure of the mounting channel and its adjustable elements (bridges) eliminates the need for unsightly inspection openings in the ceilings
- The lighting fixture can be removed and remounted without damaging the ceiling
- An LED lighting fixture with a low glare rating UGR below 19 can be built when utilizing the JUN-50 prismatic cover
- The profile can be mounted „from below” allowing to build ceiling lighting fixtures that run „wall to wall”
- Either LED tapes or LED current modules can be used
- Linear and polygonal connections are possible with ZM connectors
- Secure mounting, resistant to vibration

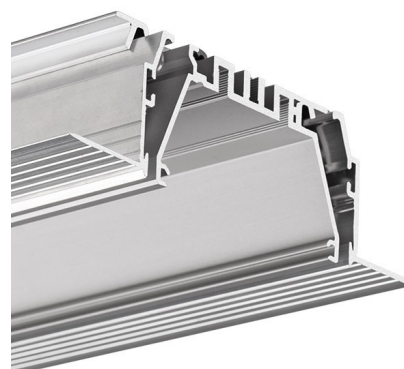

FINISH :

Non anodized (raw) 

Fill empty fields

Product nr.	
Fixture type	
Company	
Job name	
Date	

TECHNICAL SPECIFICATION

Application

- for the construction of professional lighting fixtures with a cover mounted flush with the ceiling or wall surface
- for LED lighting fixtures recessed in the ceiling, installed and serviced as a system
- for creating precise mounting channels in drywall for LED lighting fixtures
- for building LED lighting fixtures that can have a glare rating $UGR \leq 19$

Mounting

- embedding the „mounting channel” (RAM-KOZE-50) in the surface of a drywall ceiling using springs and glue.
- mounting the "core" of the lighting fixture (OMODO-50) in the “mounting channel” (RAM-KOZE-50)

Additional information

- MOD-KOZE-50 fixtures are designed for 3 LED strips (0.39"/10 mm wide), 4 strips (0.31"/8 mm wide) or a LED current module up to 0.94"/24 mm wide
- the lighting fixture is designed so that the "core" of the lighting fixture (profile with LED tapes and end caps) can be prepared in advance, in factory conditions
- the only thing to be done at the installation site is to insert the prepared “core” (OMODO-50) into the pre-installed mounting channel (RAM-KOZE-50)
- the width of the gap in the drywall for RAM-KOZE-50: from 2.60"/66 mm to 2.80"/71 mm
- two locking bolts must be used for every 39.4" (1 m) of lighting fixture. For lighting fixtures shorter than 39.4"

(1 m), at least 2 bolts

- the gaps between the edges of the mounting channel and the "core" of the fixture can be finished with a dedicated silicone cord

The following covers are compatible with MOD-KOZE-50:

- JUN-50 prismatic material: PMMA, length: 59"(1.5 m), UV resistant, glare rating UGR ≤ 19 possible
- POL-50 frosted material: PC, lengths: 39.4" (1 m), 78.7" (2 m), 118.11" (3 m), UV resistant

Animation: Extrusion system MOD-KOZE-50

span {font-weight:600;} span {font-weight:600;}

Scheme: Extrusion system MOD-KOZE-50

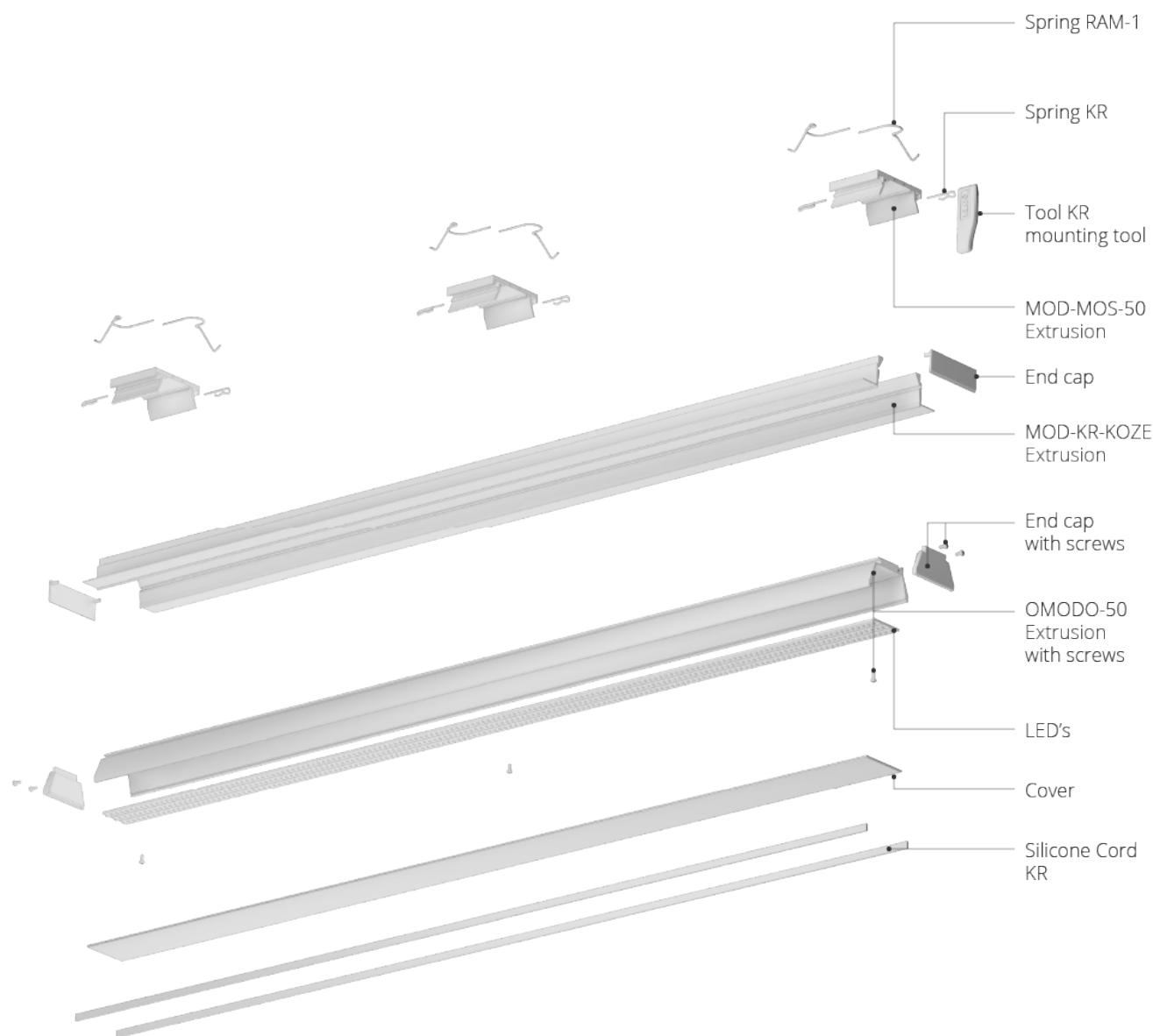

AVAILABLE LENGTHS

Ref. nr.	surface finish	available lengths
----------	----------------	-------------------

TECHNICAL DRAWING

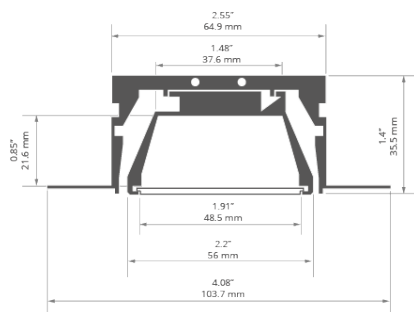

RELATED EXTRUSIONS

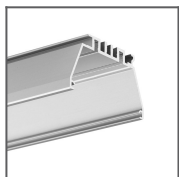

OMODO-50
Extrusion
Ref: 18053



RAM-KOZE-50
Extrusion
Ref: 18055

RELATED PRODUCTS

COVERS

CLEAR COVERS

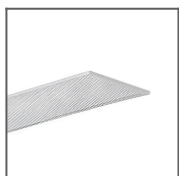

JUN-50 Prismatic
cover
Ref: 17056_1.5

FROSTED COVERS

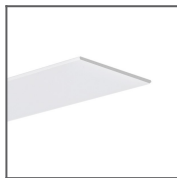

POL-50 frosted
Cover
Ref: 17058

END CAPS

REGULAR END CAPS

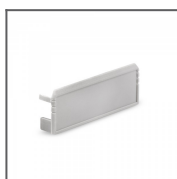

RAM-TEZE-50
grey End cap
Ref: 24350



OMODO-50 grey
End cap
Ref: 24353

ACCESSORIES

COMPONENTS FOR CONNECTING FIXTURES

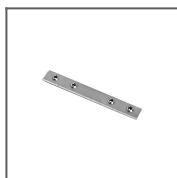

ZM-NA-180
Connector
Ref: 42724

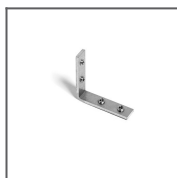

ZM-NA-PION-90
Connector
Ref: 42726

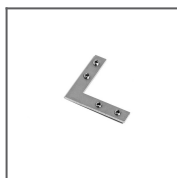

ZM-NA-90
Connector
Ref: 42723

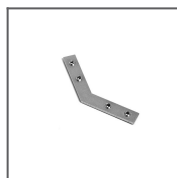

ZM-NA-135
Connector
Ref: 42725

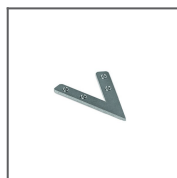

ZM-NA-45
Connector
Ref: 42339

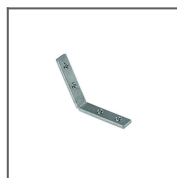

ZM-NA-PION-120
Connector
Ref: 42321



ZM-NA-PION-60
Connector
Ref: 42317



ZM-NA-PION-45
Connector
Ref: 42315

ADDITIONAL ITEMS



6x1.2 Gland
Ref: 00802



DES Gland
Ref: 42265M8X1

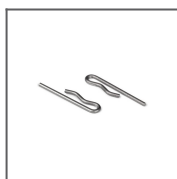

KR Spring
Ref: 42737

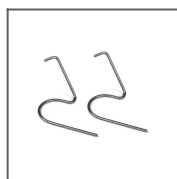

RAM-1 Spring
Ref: 42738



Mounting wedge
Ref: 70397



KR Tool
Ref: 70449