

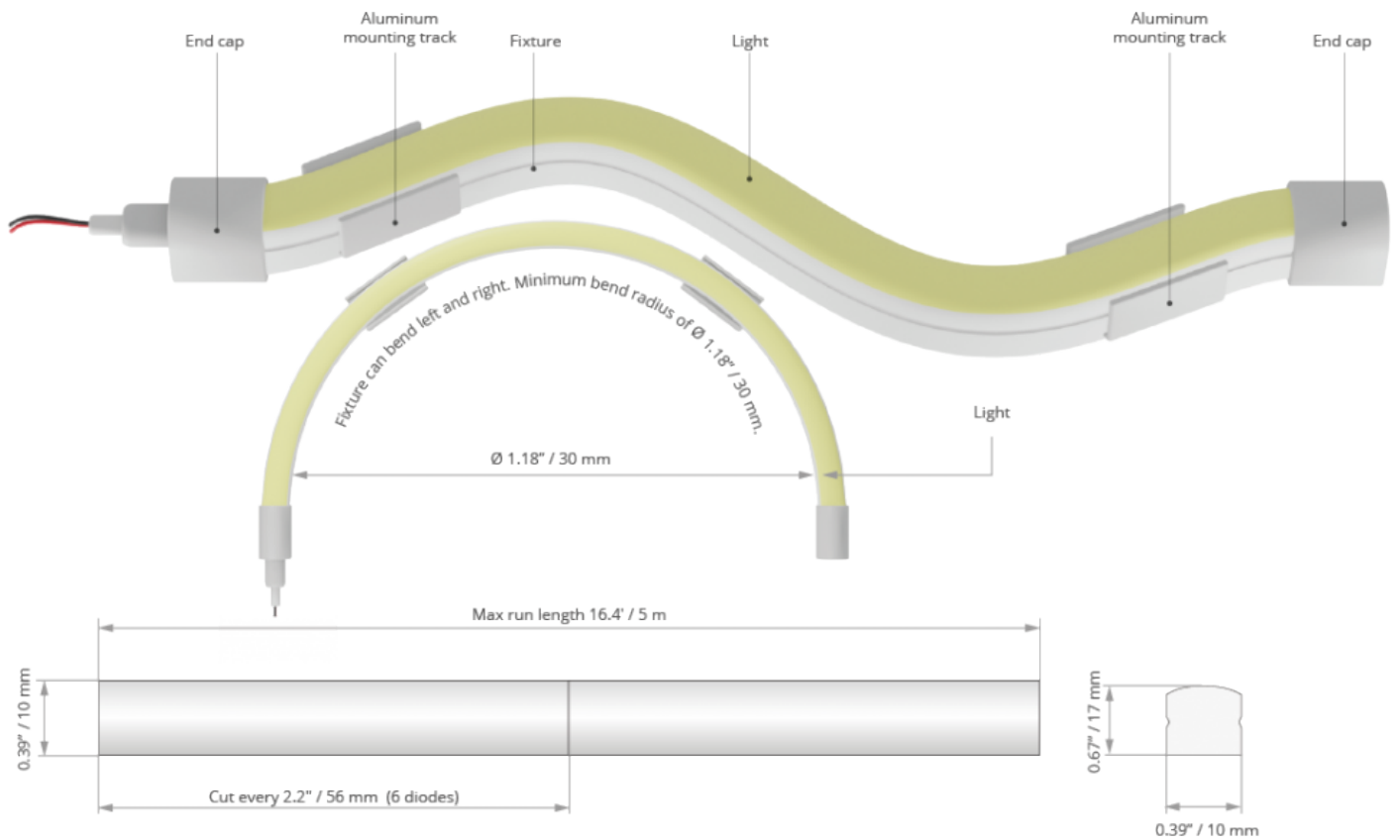



- UL Listed
- L70- Over 40,000 hours
- Reverse voltage protection
- Minimum 2oz copper PCB



* Custom lengths must be made by the factory to maintain the UL listing

TECHNICAL DATA

Model	IP protection	Power consumption	Color temperature	Diode QTY per foot	Input voltage	Beam Angle	Max run length	LED width
K-NF-RGB-1730H-24V-5M	IP 67	5.3 W/ft	Blue  Green  Red 	33 pcs/ft	24 V	120 °	16'4"	10 mm



ACCESSORIES

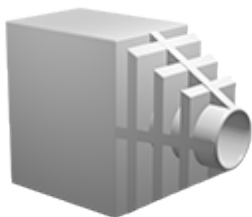

Ref. 69017 End cap with hole for K-NF-0768-24V series



Ref. 69018 End cap for K-NF-0768-24V series



Ref. 69003 Plastic mounting clip for K-NF-0768-24V series

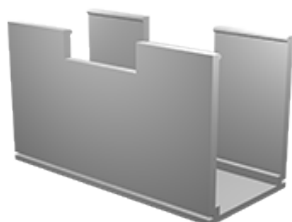

Ref. 69005 Aluminum track (1.38" / 3.5cm) for K-NF-0768-24V series, includes metal mounting clip