

Type \_\_\_\_\_  
 Project \_\_\_\_\_  
 Catalog No. \_\_\_\_\_  
 Lamp/Wattage \_\_\_\_\_

**NHMIC-685**  
**6" LED Marquise New Const. IC Housing**

Source: 850L, 120/277V

**PRODUCT DESCRIPTION**

Dedicated remodel housing for use in insulated ceilings can be in direct contact with thermal insulation. Air-tight construction provides energy savings by reducing the flow of air through the ceiling. Each LED Diamond Series Housing requires a Nora Lighting LED Diamond Series Trim Module.

**CONSTRUCTION**

**Plaster Frame**

High quality 0.040 steel die cut one piece frame

**Housing**

0.040 steel housing adjusts to maximum ceiling thickness of 1-3/4" (45mm). Spring brackets accept torsion wing trim springs.

**Clearance**

"IC" Insulated Ceiling housings are direct contact rated; no minimum clearance is required.

**Mounting**

Two bar hangers are included adjustable to 24-1/2". Bar hangers are parallel to junction box, but can be repositioned 90° perpendicular to junction box if desired. Insulation may be blown directly onto the surface of the fixture.

**Air Flow Restriction**

Meets ASTM E283 Air-Tight Requirements.

**ELECTRICAL**

**Junction Box**

Plaster frame integrated 15 cubic inch 0.064" thick galvanized steel, with seven 1/2" NPT knockouts, four Romex® pryouts, and snap on covers. Electrical connections are made through junction box wrap. Electrical grounding automatic when feeding with grounded steel EMT pipe or flex. Green wire provided installs with ground wire fed through PVC pipe conduit.

**Dimming**

[Click Here](#) or refer to [www.NoraLighting.com](http://www.NoraLighting.com) for complete updated dimmer list in the "Compatibility" page under the "Resource" tab.

**Thermal Protector**

External thermal device is located on the junction box.

**EMERGENCY**

90-minute battery back up must be ordered separately and installed apart from the housing in an accessible location.

**Lamp**

Compatible with NRM-61 Series.

**DRIVER**

- CREE LMD125 for 120V 850/1250 Lumen. ERP ELM03W-0440-34 for 277V 850/1250Lumen

**Wiring**

Standard flex whip carries wire lead from junction box into housing. Wire leads extend from housing and thermal device to the luminary disconnect.

**6" LED Marquise New Const. IC Housing**

Catalog No.	Description	Driver	Voltage	Emergency
NHMIC-685	6" 850lm New Const	(Blank)=Standard C=Comfort Dim	LE1=120V LE2=277V LE4=120V 0-10V Dim	EM=Emergency

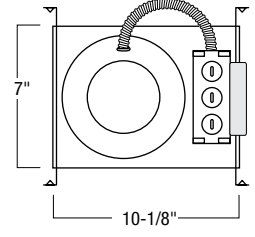
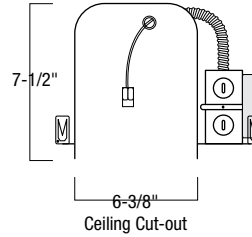

Cut-out: 6-3/8"  
 ID: 6"  
 OD: 7-1/8"

Housing Length: 10-1/8"  
 Housing Width: 7"  
 Housing Height: 7-1/2"



**Bodine Emergency Lighting Equipment: BSL17-C2/BSL17C-C2 (850/1250lm)**

- Up to 7.0W max emergency illumination with LEDs.
- Illumination Time: 90min
- Dual Input Voltage: 120/277 VAC, 60Hz
- Output Voltage: 15.0-50.0 VDC
- AC Input Current: 45 mA
- Output Current: 470mA max
- Dimension: 12" x 2.4" x 1.5"

**Labels and Listings**

cULus Listed for Damp Location w/ Feed Through  
 cULus Wet Listed (Only with designated trims)  
 Meets or exceeds ASTM-283 Air-Tight Requirements  
 Title 24  
 Energy Star